

FROM: GLA, Glastonbury Landowners Association  
PO Box 312, Emigrant, MT. 59027

RECEIVED  
OCT 20 2017  
BY: SOPHIA

10-10-2017

TO: Jessica Mayo /Anderson  
Park Conservation District  
5242 Hwy. 89 South, Livingston, MT. 59047

RE: 310 Application for Hercules Rd/ Golmeyer Creek erosion

Dear Jessica,

It took a little while to get everything together, but with the winter approaching we must do something soon. Please note the attached.

All we essentially want to do, is to reclaim/restore the road to its original width for safe driving. In the process we will need to redirect Golmeyer Creek to where it was running before. This will be done with minimal impact on the environment.

We greatly appreciate your expedient processing of this application. I am a neighbor a little upstream of the erosion point and are available to go over this with you and your team as needed. Denis Riley, President of the GLA is also a neighbor and available when he is here.

Thanks for your help and Best Regards,

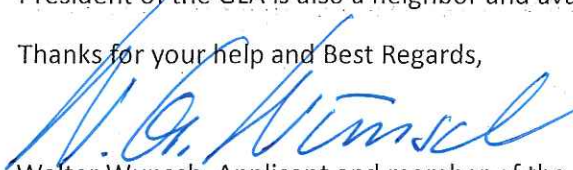
  
Walter Wunsch, Applicant and member of the GLA Road Committee.

  
Denis Riley, President of the GLA

ATTACHMENTS:

- 1] 310 form 270: 4 pages
- 2] Arial View of erosion location with coordinates.
- 3] Drwg of location, plain view
- 4] Cross-sectional Drwg at point of erosion

cc: U.S. Army Corps of Engineers  
Park County Floodplain Admin.

Revised: 6/5/15 (310 form 270). Form may be downloaded from: <a href="http://www.dnrc.mt.gov/licenses-and-permits/stream-permitting">www.dnrc.mt.gov/licenses-and-permits/stream-permitting</a>	AGENCY USE ONLY: Application # _____ Date Received _____ Date Accepted _____ / Initials _____ Date Forwarded to DFWP _____
<p><i>This space is for all Department of Transportation and SPA 124 permits (government projects).</i></p> Project Name _____ Control Number _____ Contract letting date _____ MEPA/NEPA Compliance <input type="checkbox"/> Yes <input type="checkbox"/> No If yes, #14 of this application does not apply.	

**RECEIVED**  
**OCT 20 2017**  
 BY: COE HINE

**JOINT APPLICATION FOR PROPOSED WORK IN MONTANA'S STREAMS, WETLANDS, FLOODPLAINS, AND OTHER WATER BODIES**

Use this form to apply for one or all local, state, or federal permits listed below. The applicant is the responsible party for the project and the point of contact unless otherwise designated. "Information for Applicant" includes agency contacts and instructions for completing this application. To avoid delays, submit all required information, including a project site map and drawings. Incomplete applications will result in the delay of the application process. Other laws may apply.

**The applicant is responsible for obtaining all necessary permits and landowner permission before beginning work.**

✓	PERMIT	AGENCY	FEE
*	310 Permit	Local Conservation District	No fee
	SPA 124 Permit	Department of Fish, Wildlife and Parks	No fee
	Floodplain Permit	Local Floodplain Administrator	Varies by city/county (\$25 - \$500+)
	Section 404 Permit, Section 10 Permit	U. S. Army Corps of Engineers	Varies (\$0 - \$100)
	318 Authorization 401 Certification	Department of Environmental Quality	\$250 (318); \$400 - \$20,000 (401)
	Navigable Rivers Land Use License, Lease, or Easement	Department of Natural Resources and Conservation, Trust Lands Management Division	\$50, plus additional fee

**A. APPLICANT INFORMATION**

NAME OF APPLICANT (person responsible for project): Walter G. Wunsch  
 Has the landowner consented to this project?  Yes  No  
 Mailing Address: PO Box 36, Emigrant, MT 59027  
 Physical Address: 27 Polaris Way, Emigrant, MT 59027  
 Day Phone: 406-333-4444 Evening Phone: 406-223-4444 E-Mail: walter@spectecsensors.com

NAME OF LANDOWNER (if different from applicant): GLA, Glastonbury Landowners Association;  
 Mailing Address: PO Box 312; Emigrant, MT 59027  
 Physical Address: NA  
 Day Phone: 406-451-0033 Evening Phone: 406-223-7641 E-Mail: info@glamontana.org

NAME OF CONTRACTOR/AGENT ): NA  
 Mailing Address: NA  
 Physical Address: NA  
 Day Phone: NA Evening Phone: NA E-Mail: NA

**B. PROJECT SITE INFORMATION**

NAME OF STREAM or WATER BODY at project location Golmeyer Creek Nearest Town Emigrant  
 Address/Location: End of Hercules Rd Geocode (if available): SWSWSWSWNE  
 Choose. 1/4 Choose. 1/4 Choose. 1/4, Section 2, Township TS6, Range R7E County Park  
 Longitude 45.20.43.58N, Latitude 110.49.39.42W

The state owns the beds of certain state navigable waterways. Is this a state navigable waterway? Yes or No. If yes, send copy of this application to appropriate DNRC land office – see Information for Applicant.

**ATTACH A PROJECT SITE MAP OR A SKETCH** that includes: 1) the water body where the project will take place, roads, tributaries, landmarks; 2) a circled "X" representing the exact project location. **IF NOT CLEARLY STATED ON THE MAP OR SKETCH, PROVIDE WRITTEN DIRECTIONS TO THE SITE, >>>>**  
>>> ~6miles from Drycreek, 200yds before the end of Hercules Rd and the intersection with Saggitarius Skyway

### C. PROJECT INFORMATION

1. **TYPE OF PROJECT** (check all that apply)

- |   |  |  |
|---|--|--|
| <input type="checkbox"/> Bridge/Culvert/Ford Construction         | <input type="checkbox"/> Fish Habitat                      | <input type="checkbox"/> Mining            |
| <input type="checkbox"/> Bridge/Culvert/Ford Removal              | <input type="checkbox"/> Recreation (docks, marinas, etc.) | <input type="checkbox"/> Dredging          |
| <input checked="" type="checkbox"/> Road Construction/Maintenance | <input type="checkbox"/> New Residential Structure         | <input type="checkbox"/> Core Drill        |
| <input checked="" type="checkbox"/> Bank Stabilization/Alteration | <input type="checkbox"/> Manufactured Home                 | <input type="checkbox"/> Placement of Fill |
| <input type="checkbox"/> Flood Protection                         | <input type="checkbox"/> Improvement to Existing Structure | <input type="checkbox"/> Diversion Dam     |
| <input type="checkbox"/> Channel Alteration                       | <input type="checkbox"/> Commercial Structure              | <input type="checkbox"/> Utilities         |
| <input type="checkbox"/> Irrigation Structure                     | <input type="checkbox"/> Wetland Alteration                | <input type="checkbox"/> Pond              |
| <input type="checkbox"/> Water Well/Cistern                       | <input type="checkbox"/> Temporary Construction Access     | <input type="checkbox"/> Debris Removal    |
| <input type="checkbox"/> Excavation/Pit                           | <input type="checkbox"/> Other _____                       |  |

2. **PLAN OR DRAWING** of the proposed project **MUST** be attached. **This plan or drawing must include:**

- a plan view (looking at the project from above)
- dimensions of the project (height, width, depth in feet)
- location of storage or stockpile materials
- drainage facilities
- an arrow indicating north
- a cross section or profile view
- an elevation view
- dimensions and location of fill or excavation sites
- location of existing or proposed structures, such as buildings, utilities, roads, or bridges

3. **IS THIS APPLICATION FOR** an annual maintenance permit?  Yes  No  
(If yes, an annual plan of operation must be attached to this application – see "Information for Applicant")

4. **PROPOSED CONSTRUCTION DATE.** Include a project timeline. Start date Click here to enter a date.  
Finish date ASAP before Snowfall Is any portion of the work already completed?  Yes  No  
(If yes, describe the completed work.)

5. **WHAT IS THE PURPOSE** of the proposed project?  
For safety and to protect the road. Road has narrowed due to erosion

6. **PROVIDE A BRIEF DESCRIPTION** of the proposed project.  
Redirect the creek into previous channels of flow. Stabilize the bank by placing boulders at the base and fill with rock and dirt/gravel.

7. **WHAT IS THE CURRENT CONDITION** of the proposed project site? Describe the existing bank condition, bank slope, height, nearby structures, and wetlands.  
The existing bank is being eroded and undermines the road. Cracks are visible on the edge of the road. See attached cross-sectional drwg.

8. **PROJECT DIMENSIONS.** How many linear feet of bank will be impacted? How far will the proposed project encroach into and extend away from the water body?  
~10-20ft

9. **VEGETATION.** Describe the vegetation present on site. How much vegetation will be disturbed or covered with fill material during project installation? (Agencies require that only vegetation necessary to do the work be removed.) Describe the revegetation plan for all disturbed areas of the project site in detail.  
Currently almost no vegetation due to erosion. What is there are almost exclusively weeds.

10. **MATERIALS.** Describe the materials proposed to be used. Note: This may be modified during the permitting process. It is recommended you do not purchase material until all permits are issued.

Cubic yards/Linear feet	Size and Type	Source
~25cyrds / ~20ft	Bolders/Rocks/Dirt/Gravel	From neighbors

11. **EQUIPMENT.** List all equipment that will be used for construction of the project. How will the equipment be used on the bank and/or in the water? Note: Make sure equipment is clean and free of weeds, weed seeds, and excess grease before using it in the water waterway. To prevent the spread of aquatic invasive species, to the extent practical, remove mud and aquatic plants from heavy machinery and other equipment before moving between waters and work sites, especially in waters known to be infested with aquatic invasive species. Drain water from machinery and let dry before moving to another location.

Backhoe

12. **DESCRIBE PLANNED EFFORTS TO MINIMIZE PROJECT IMPACTS.** Consider the impacts of the proposed project, even if temporary. What efforts will be taken to:

- Minimize erosion, sedimentation, or turbidity?

The very purpose of this project is to minimize erosion

- Minimize stream channel alterations?

The stream channel needs to be redirected of where is has been in the past.

- Minimize effects to stream flow or water quality caused by materials used or removal of ground cover?

NA

- Minimize effects on fish and aquatic habitat?

NA

- Minimize risks of flooding or erosion problems upstream and downstream?

YES!

- Minimize vegetation disturbance, protect existing vegetation, and control weeds?

YES!

13. **WHAT ARE THE NATURAL RESOURCE BENEFITS** of the proposed project?

The creek will be happier....seriously, as it will minimize the possibility of people driving over the bank into the creek and causing a oil/gasoline spill.

14. **LIST ALTERNATIVES** to the proposed project. Why was the proposed alternative selected?

NONE

**D. ADDITIONAL INFORMATION FOR SECTION 404, SECTION 10, AND FLOODPLAIN PERMITS ONLY.**

If applying for a Section 404 or Section 10 permit, fill out questions 1-3. If applying for a floodplain permit, fill out questions 3-6. (Additional information is required for floodplain permits – See “Information for Applicant.”)

1. Will the project involve placement of dredged (excavated) and/or fill material below the ordinary high water mark, in a wetland, or other waters of the US? If yes, what is the surface area to be filled? How many cubic yards of fill material will be used? Note: Wetland delineations are required if wetlands are affected.

NA

2. Description of avoidance, mitigation, and compensation (see Information for Applicant). Attach additional sheets if necessary.

NA

3. List the names and address of landowners adjacent to the project site. This includes properties adjacent to and across from the project site. (Some floodplain communities require certified adjoining landowner lists).

NA, as the site is within the GLA road easement. Also, this work will benefit all landowners, which alerted the GLA to this condition.

4. List all applicable local, state, and federal permits and indicate whether they were issued, waived, denied, or pending. Note: All required local, state, and federal permits, or proof of waiver must be issued prior to the issuance of a floodplain permit.

NA

5. Floodplain Map Number NA

6. Does this project comply with local planning or zoning regulations?  Yes  No

**E. SIGNATURES/AUTHORIZATIONS -- Each agency must have original signatures signed in blue ink.**

**After completing the form**, make the required number of copies and **then sign each copy**. Send the copies with original signatures and additional information required directly to each applicable agency.

The statements contained in this application are true and correct. The applicant possess' the authority to undertake the work described herein or is acting as the duly authorized agent of the landowner. The applicant understands that the granting of a permit does not include landowner permission to access land or construct a project. Inspections of the project site after notice by inspection authorities are hereby authorized.

APPLICANT (Person responsible for project):

Print Name: Walter G. Wunsch

LANDOWNER:

Print Name: Denis Riley, President of GL:A

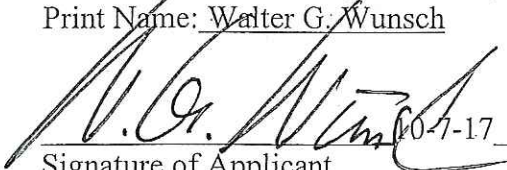
 Signature of Applicant

10-7-17 10-9-17 Date

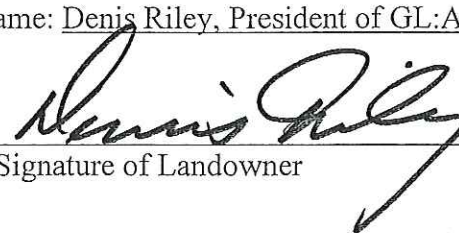
 Signature of Landowner

10-10-17 Date

\*CONTRACTOR/AGENT:

Print Name: [Click here to enter name.](#)

NA

\_\_\_\_\_  
Signature of Contractor/Agent      Date

\*Contact agency to determine if contractor signature is required.

ATTACHMENT 2

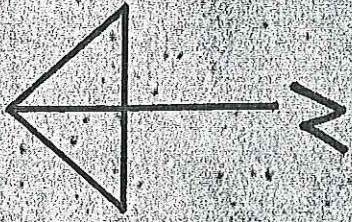

45 20 43 58N  
110 49 39 42W

B. Minor Point

Major



Erosion

SWSWSW SWNE Sec. 2, T6S, R7E

Handwritten initials or signature in the top right corner.

ATTACHMENT 3

HERCULES ROAD

EROSIONS

SOUTH CAROLINA

TRIGRANT, N.T. 59027

A-A: MAJOR EROSION POINT #1

B: MINOR " #2

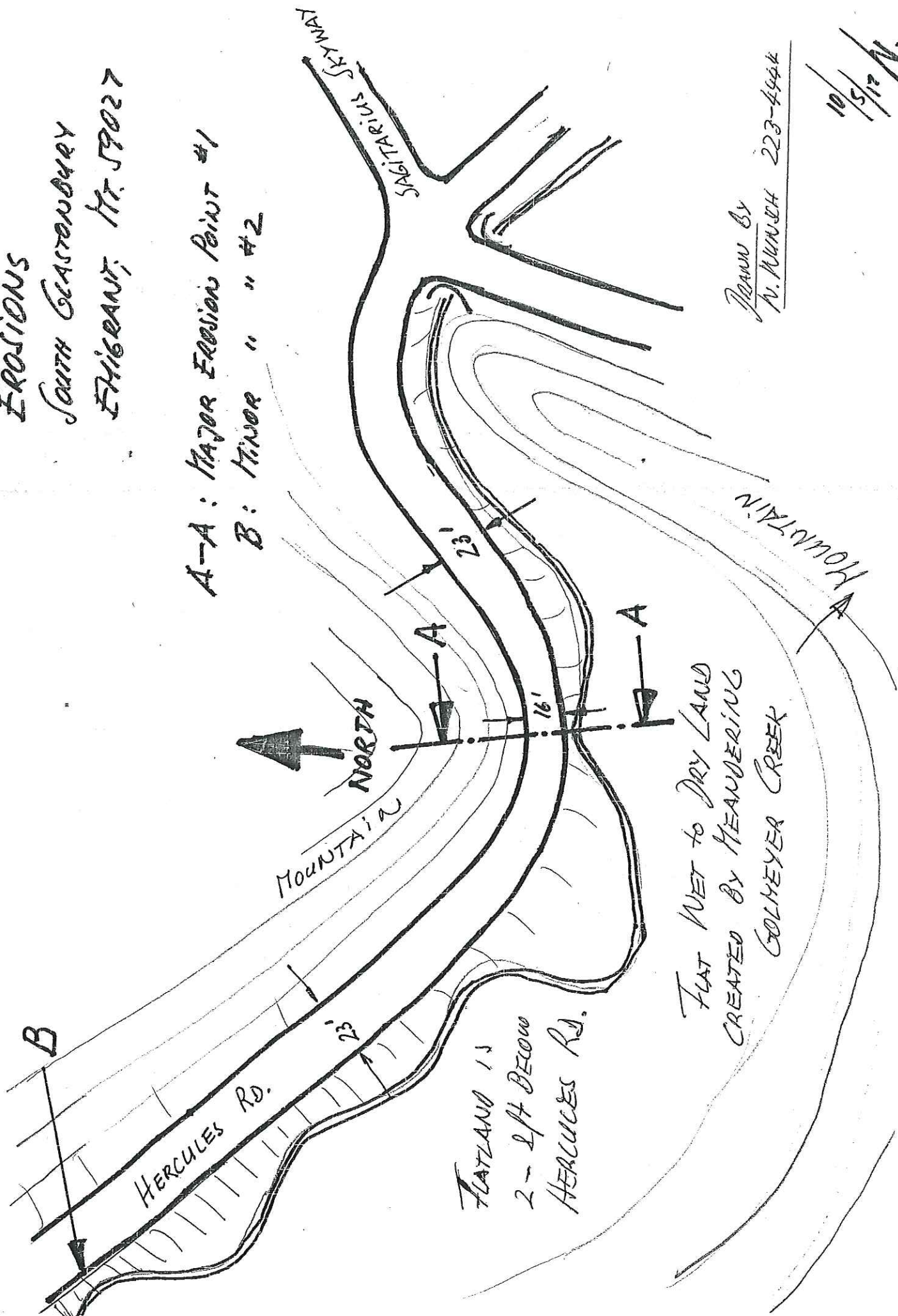

DRAWN BY  
M. MUNCH 223-4444

10/5/17 N.

FLAT NET TO DRY LAND  
CREATED BY MEANDERING  
COLMEYER CREEK

FLATLAND IS  
2- 2/4 BELOW  
HERCULES RD.

# Hercules Road Erosion

## In South Glastonbury

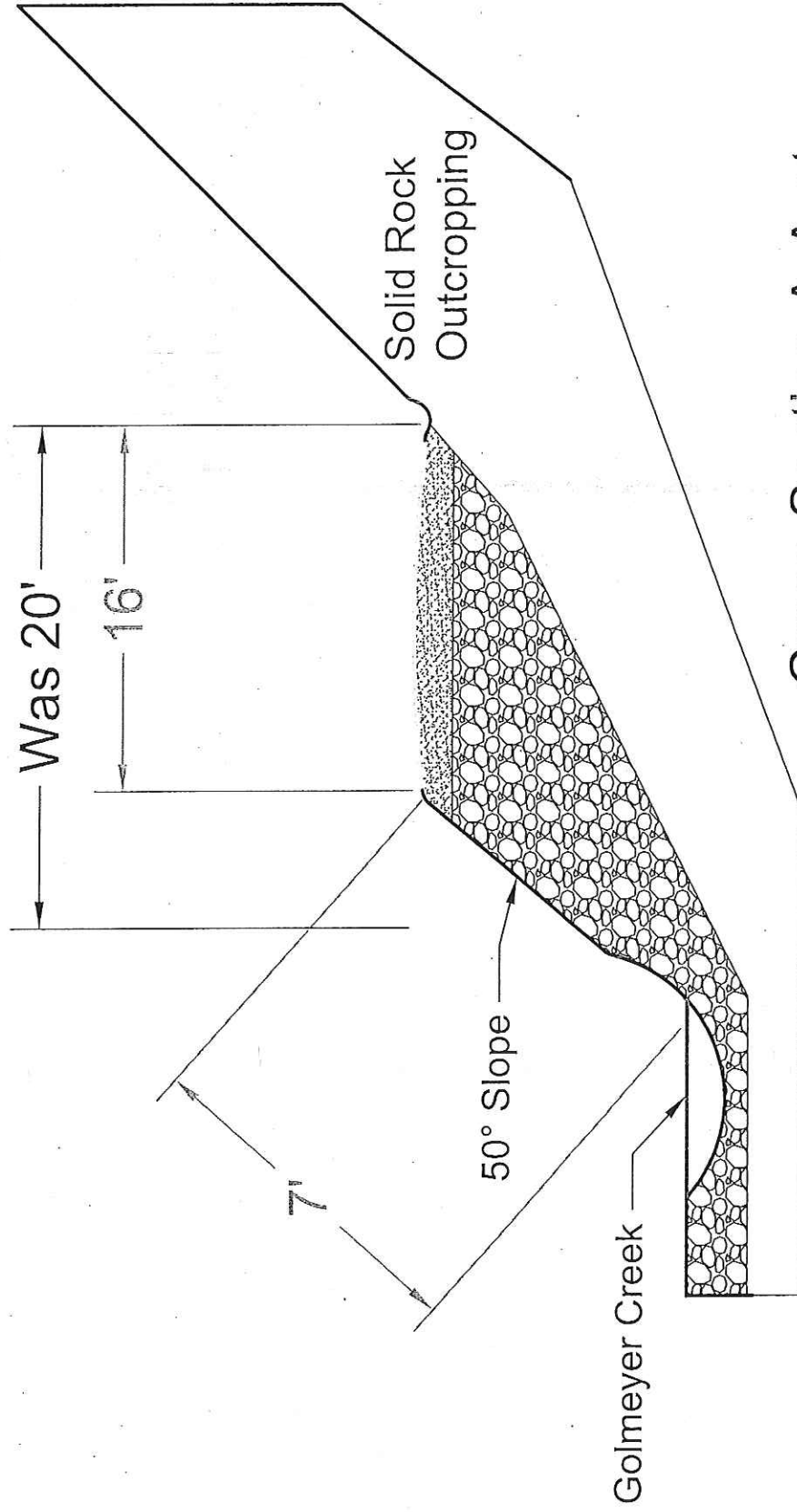

Cross Section A-A at  
Erosion Point #1

10-6-2017  
CW